

# THE LAUREL

2 Bedroom Bungalow



Artist's Impression

A modern two bedroom semi-detached bungalow.

Plots: 3, 4, 109, 110

# THE LAUREL

2 Bedroom Bungalow

## Ground Floor

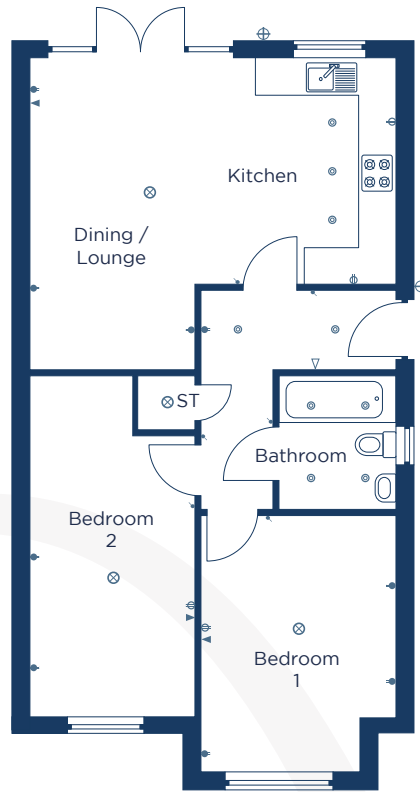

### Kitchen

3200 x 3700      10'6" x 12'2"

### Dining / Lounge

2700 x 5100      8'10" x 16'9"

### Bedroom 1

3200 x 4250      10'6" x 13'11"

### Bedroom 2

2700 x 5600      8'10" x 18'5"

### Bathroom

1900 x 2200      6'3" x 7'3"

 Low level  
socket

 High level  
socket

 Pendant  
light

 External  
light

 Fluorescent  
light

 Spotlight

 Light switch

 TV point

 BT point

**CONSUMER  
CODE FOR  
HOME BUILDERS**

[www.consumercode.co.uk](http://www.consumercode.co.uk)

[danumhomes.co.uk](http://danumhomes.co.uk)

All information contained in this leaflet is taken from design intent material and may be subject to further design development. Images are for illustration only and do not form part of any contract of sale. The dimensions and layouts given are estimated and for guidance only and are subject to chosen plot. T2 6663 Revision Date: 13.03.26 Revision: 02

The **Wolds**